

VERTICAL BLIND FITTING INSTRUCTIONS

Please find enclosed appropriate brackets and wood screws for either top fix or face fix.

1. Fixings

Top fix

wood screws x1 per bracket

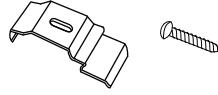

Face fix

(also to be used where there are projections in the wall)

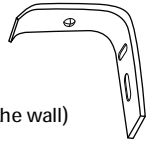

2. Top fix

a) Fitting the brackets

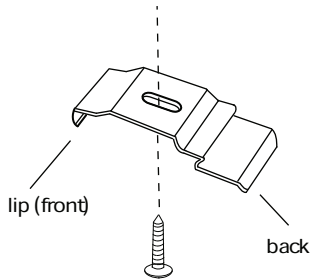

Brackets should be fixed to the ceiling or lintel with holes drilled on a line at least 3" (75mm) from the wall or window frame for blinds with 127mm (5") louvres or 55mm (2") for blinds with 89mm (3½") louvres. When marking out where brackets are to go, please bear in mind that end brackets should be about 1½" (40mm) from the ends of the track. Depending on the width of your blind you may be supplied with additional brackets - these should be spaced evenly along the width of the blind.

b) Fitting the track

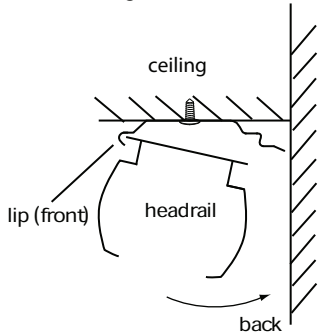

Track must be fitted into brackets keeping controls to the side ordered. Slip front edge of track into lip at front of the bracket and push the back of the track in and up in a backwards movement until it clicks into place.

The track is now firmly held in place with no further adjustment required. Remove packing material from track releasing the cord and chain. Cord control traverses louvres and chain control rotates them.

4. Fitting the Louvres

Turn the hooks on the top of the louvres so that the slots are 90 degrees to the track. Hang louvres keeping all seams one way. Finally clip the bottom chain into place along the front and back of the louvres. Your blind is now ready to operate.

IMPORTANT

DO NOT TRAVERSE BLINDS WITH LOUVRES IN CLOSED POSITION. ALWAYS TURN THEM 90 DEGREES TO THE TRACK BEFORE OPERATING CORD CONTROL

3. Face fix

a) Fitting the brackets

Fix brackets to wall or frame as close as possible to the ceiling or lintel with same spacing as recommended for top fix brackets.

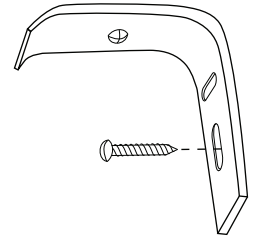

b) Fitting the track

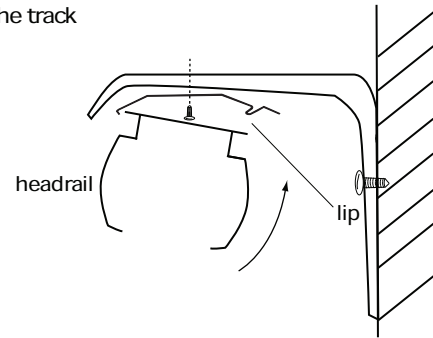

Track must be fitted into brackets keeping controls to the side ordered. Slip front edge of track into lip at front of the bracket and push the back of the track in and up in a backwards movement until it clicks into place.

The track is now firmly held in place with no further adjustment required. Remove packing material from track releasing the cord and chain. Cord control traverses louvres and chain control rotates them.

5. Installing the tension device

This tension device reduces the the hazards of strangulation and entanglement of young children by limiting access to the control chain. Fit the tension device as per the diagrams below. Please ensure you fit this Tension Device at the maximum vertical distance from the control mechanism to prevent the chain from becoming slack.

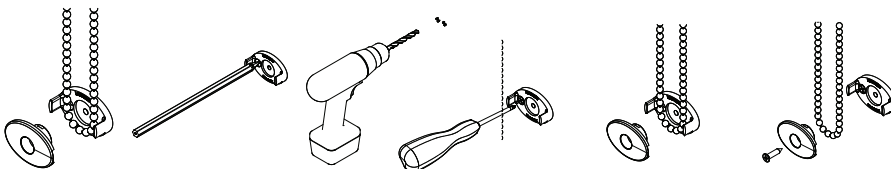

! WARNING

Young children can be strangled by loops in pull cords, chains, tapes and inner cords that operate the product. To avoid strangulation and entanglement, keep cords out of the reach of young children. Cords may become wrapped around a child's neck. Move beds, cots and furniture away from window covering cords. Do not tie cords together. Make sure cords do not twist and create a loop.

